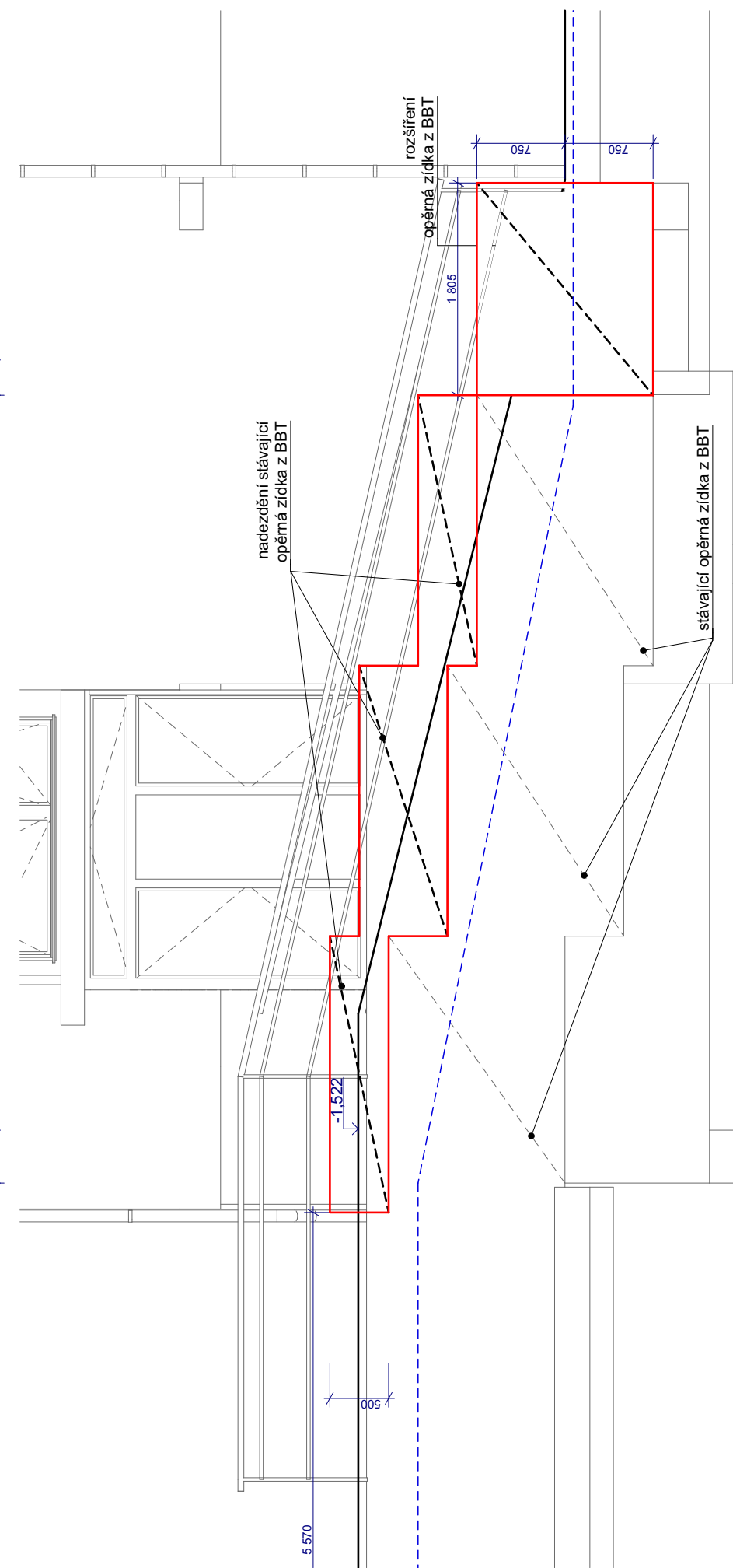
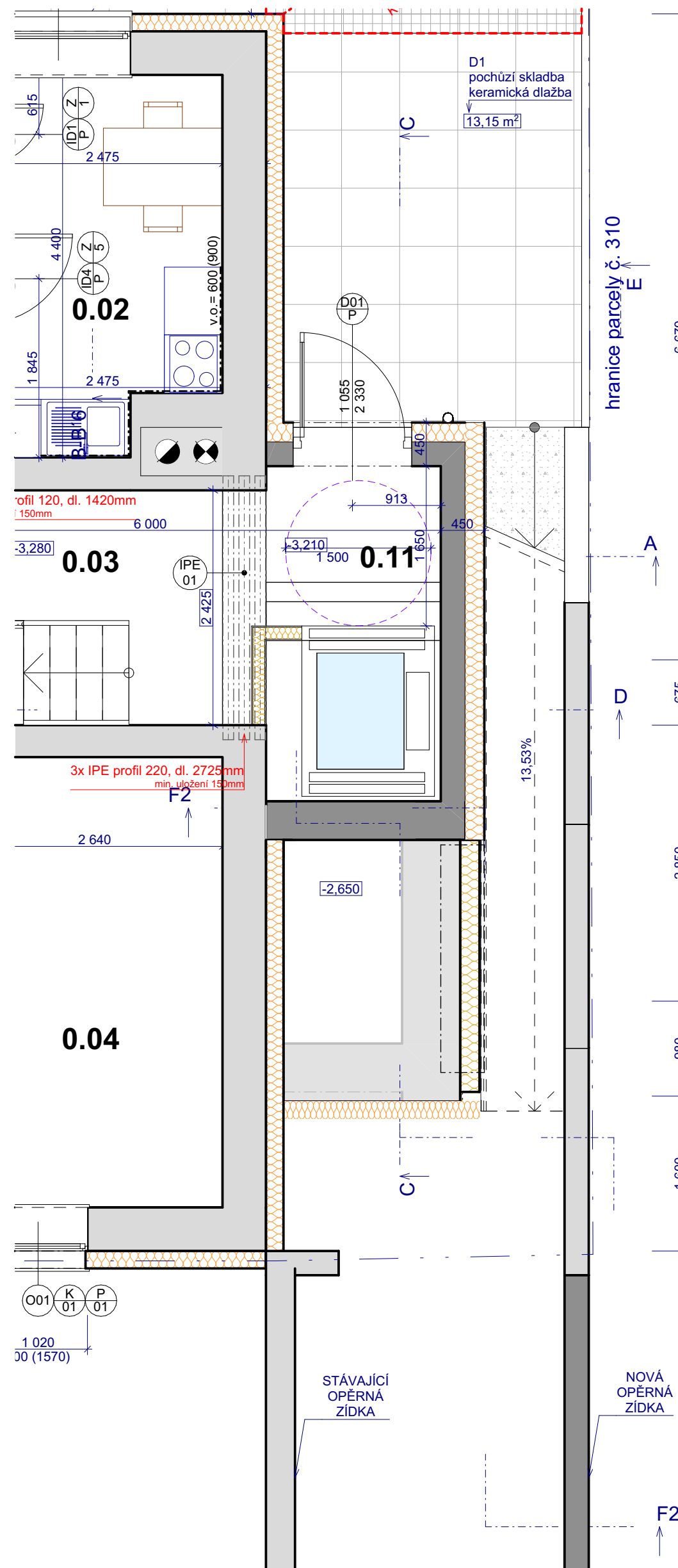

Technical drawing of a building foundation cross-section. The drawing shows a concrete foundation wall and a base. Key dimensions and features include:

- Dimensions:**
 - Vertical dimension: 2 895
 - Vertical dimension: 1 065
 - Horizontal dimension: -3,210
 - Horizontal dimension: -4,310
 - Horizontal dimension: -4,510
- Labels:**
 - hloubka základu neověřena (depth of foundation not verified)
 - zateplení soklové části tl.160mm (insulation of the base part, thickness 160mm)
- Details:**
 - Foundation wall and base are shown in grey.
 - Insulation is shown in yellow with a wavy pattern.
 - Reinforcement bars are shown in the foundation wall.
 - A vertical section of the wall is shown on the right, labeled with 'a' and 'b'.

Technical cross-section drawing of a window frame assembly. The drawing shows a window pane (blue) set in a frame (grey) with various seals and insulation (hatched areas). Dimensions are provided in millimeters. Labels indicate 'zateplení prahu dřevě - purenit' (thermal insulation of the wooden sill - polyurethane) and 'zateplení soklové části tl 160mm (vč. novové fólie)' (thermal insulation of the base part 160mm thick, including new foil).

[illegible]

Architektonicko - stavební řešení

stavebník: Jihomoravský kraj
Žerotínovo náměstí 449/3
601 82 Brno

datum:	04/2024
--------	---------

obsah výkresu:

Výtah

Vojanova č.1, 615 00 Brno
tel.: +420 604 / 711 260
E-mail: petr.blazek@pend.cz, www.pend.cz

měřítka:	čís. výkresu:
----------	---------------

1:50 D 1.28